

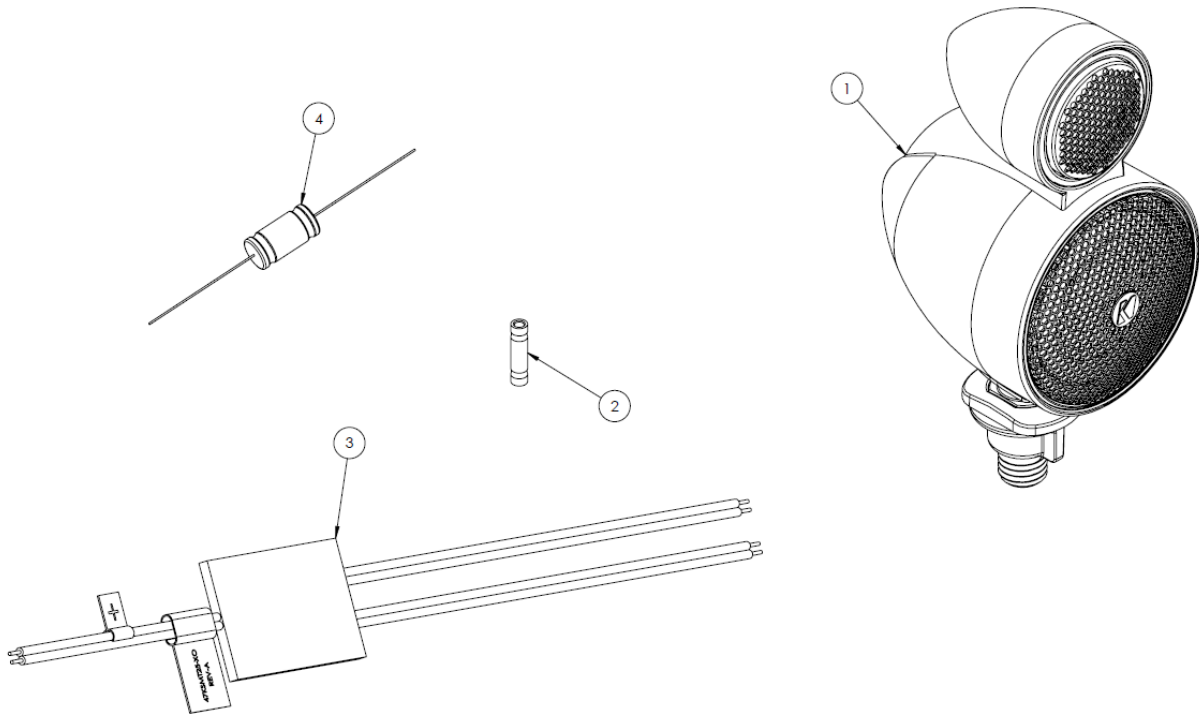

PARTS LIST

| ITEM NO. | DESCRIPTION | QTY. |
|----------|---|------|
| 1 | 47KSMT25 POD ASSEMBLY WITH NUT AND WASHER | 2 |
| 2 | BUTT CONNECTOR | 4 |
| 3 | 47KSMT25 CROSSOVER | 2 |
| 4 | CAPACITOR | 2 |





The Kicker KSMT25 pod provides a mid and tweeter with optimized adjustability. The pod can be mounted to almost any surface where a hole can be drilled. Not only does the entire pod assembly pivot, lean, and rotate on the ball and socket mounting stud - the tweeter also has approximately 260 degrees of planetary rotation around the mid to provide desired orientation. This document demonstrates adjusting, mounting, and wiring of the KSMT25 pod assembly for the following Kicker models:

- **47KSMT2504**

PARTS IDENTIFICATION

Below is a list describing part names used in these instructions.

- (1) KSMT25 pod assembly
- (2) Tweeter
- (3) Mid
- (4) Mounting Stud
- (5) Decorative Plug
- (6) Washer
- (7) Wing Nut

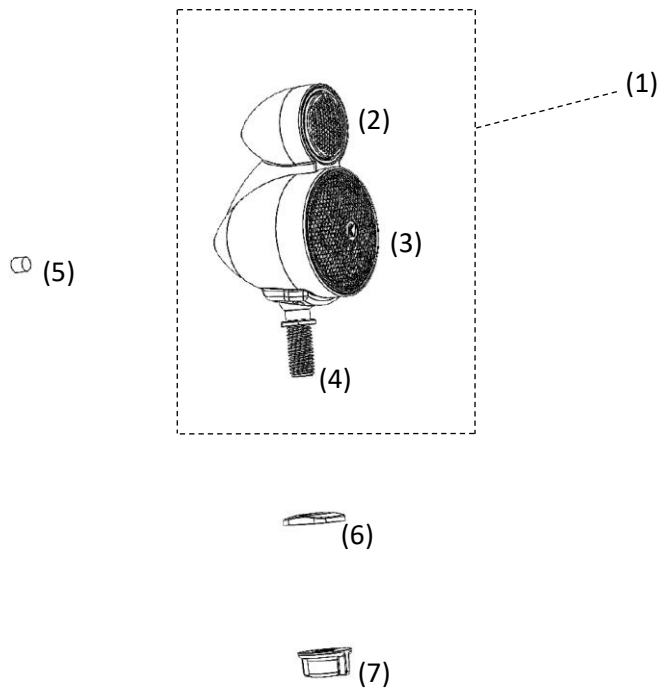



**READ AND UNDERSTAND ALL OF THESE INSTRUCTIONS BEFORE
INSTALLATION!**

ADJUSTABILITY OF THE KSMT25 POD

The KSMT25 tweeter pod assembly pivots and rotates on its mounting stud. This can be accomplished any time before or after installation.

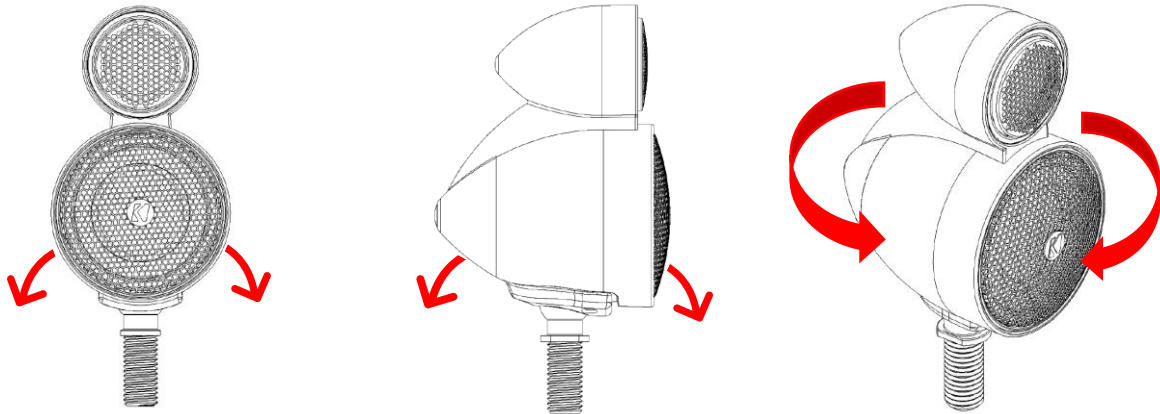

1. To adjust the rotation of the tweeter around the mid, remove the decorative plug at the back of the pod assembly. Using a 2.5mm allen wrench, loosen (do not remove) the bolt retaining the tweeter to the mid.

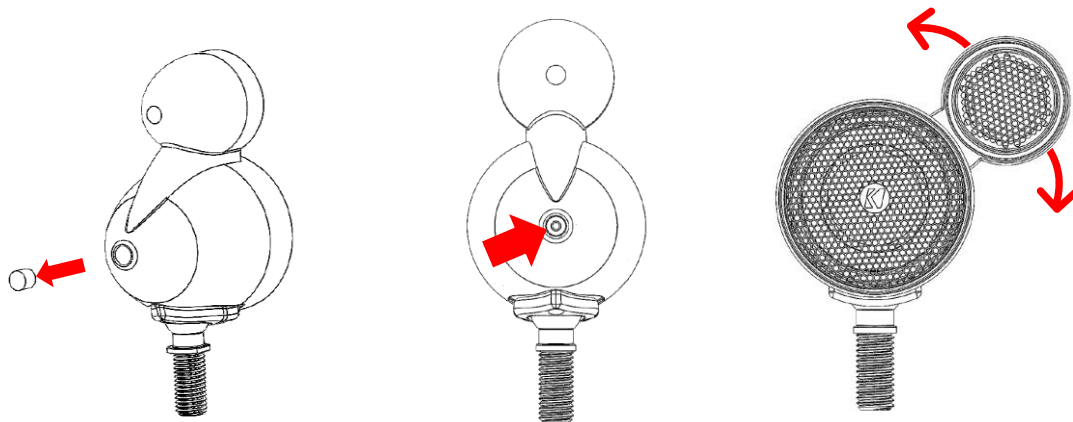

2. Rotate the tweeter to the desired location and retighten the bolt. Replace the decorative plug.



TIGHTENING THE BALL AND SOCKET MOUNT

If the pod assembly will not remain stationary on the stud, the ball and socket clamp can be tightened to prevent pod movement.

1. Remove the nut and washer from the stud.
2. Using a 2mm allen wrench, tighten the three bolts on the bottom of the pod to increase clamping force on the ball and socket.

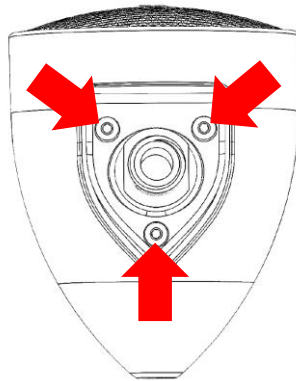

MOUNTING THE KSMT25 TWEETER POD

Choose a mounting surface that can be accessed from both side as a wing nut must be installed on the mounting stud to retain the pod in its location.

1. Drill a 9/16" hole in the desired mounting location.

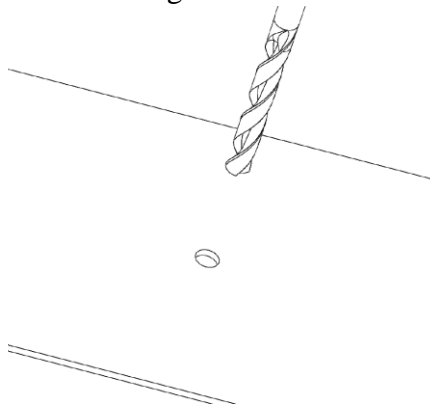



- Place the washer on the mounting stud then insert the mounting stud into the drilled hole. Secure the pod assembly to the mounting surface with the wing nut.

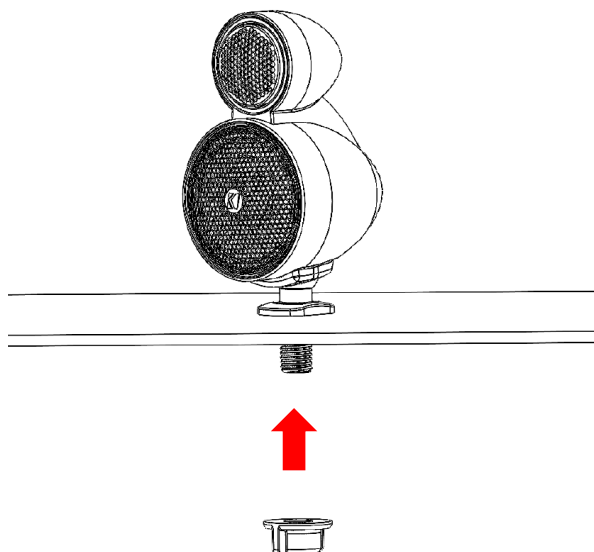

CONNECTING THE CROSSOVERS TO THE PODS



DANGER! Electrical hazard. Burns, electric shock, or damage to equipment may occur during connection of electrical wires. Always disconnect the vehicle's power source before making wire connections.

Kicker supplies crossovers with KSMT25 to optimize the sound of the pod's speakers. The KSMT25 crossover is terminated so that it will only connect to the KSMT25 assembly.

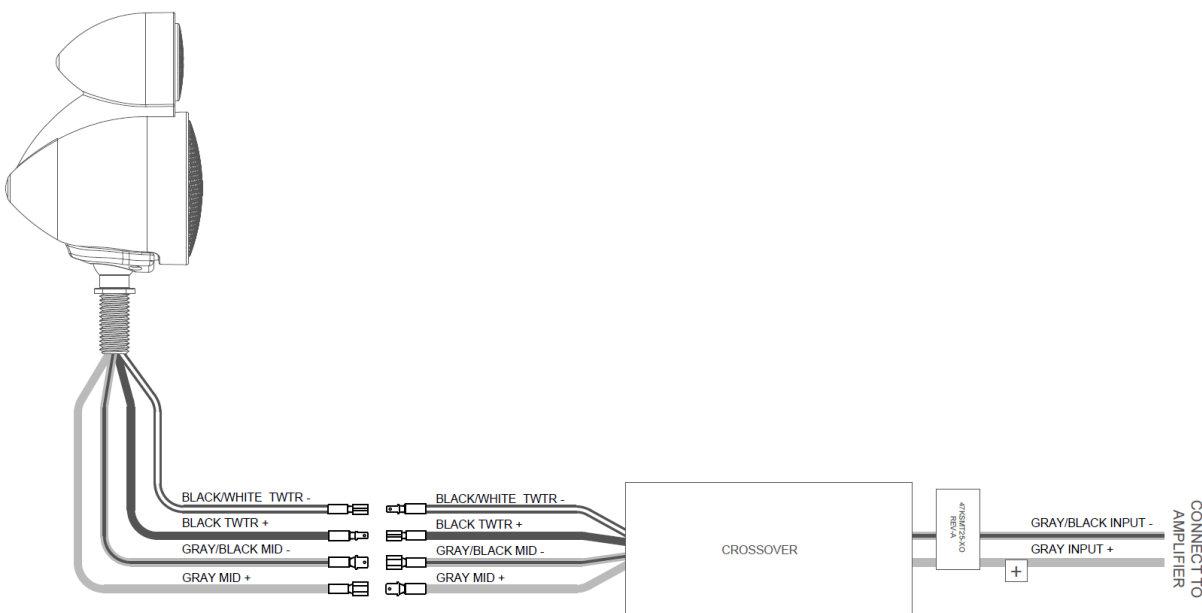



NOTE: The KSMT25 crossover is labeled with the part number 47KSMT25-XO.



1. Connect the crossover terminals and receptacles to their respective mating connector on the KSMT25 pod assembly. The terminals on the 47KSMT25 crossover are all different sizes and types to prevent incorrect connection. Also, the crossover wire colors match the pod assembly wire colors.

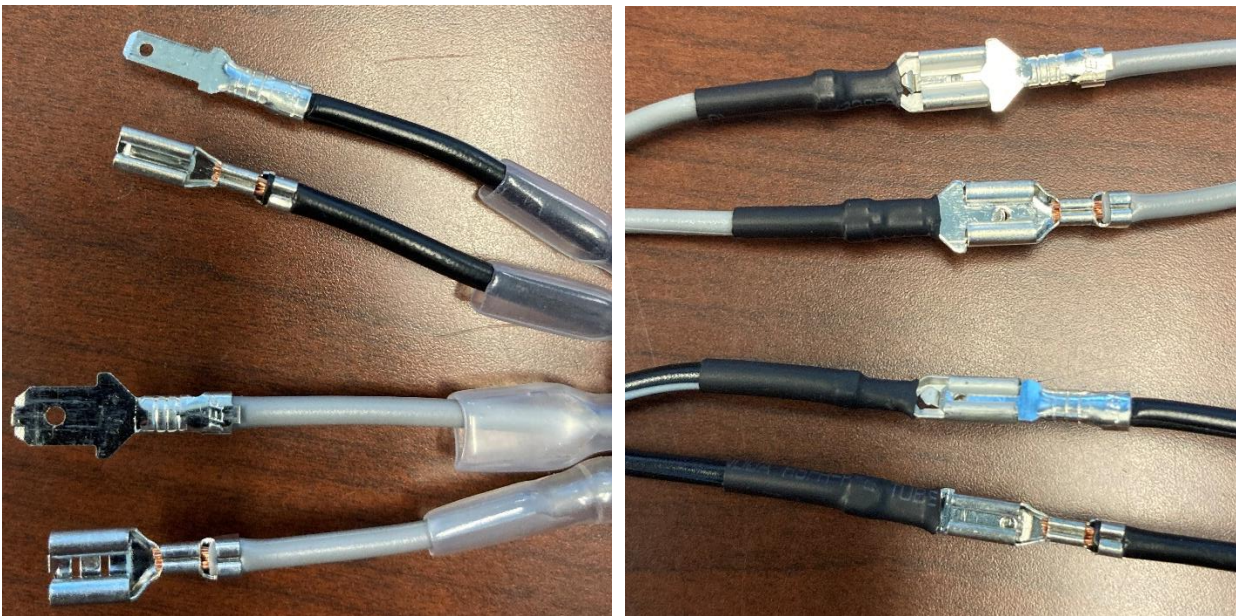



2. Slide the clear cover over the terminals to prevent a short circuit.



3. Connect the crossover input to the outputs of the head unit or amplifier using the supplied butt connectors. The positive lead is the wire with gray insulation labeled with a “plus” symbol. The negative lead has gray insulation with a black stripe on it.

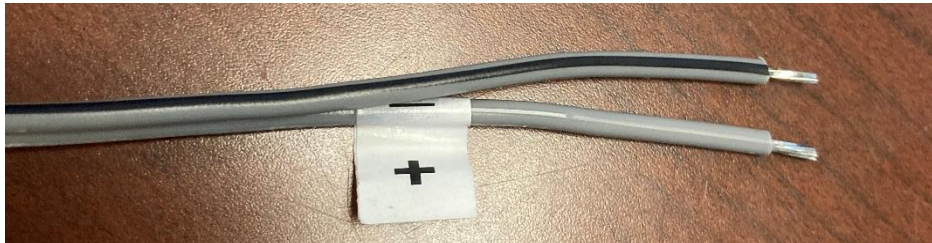



CONNECTING CAPACITORS TO CROSSOVERS

When using an active crossover **DO NOT** use the supplied capacitors. Instead tune the amplifier channel powering the KSMT25 to play above 400 hertz at 12db per octave slope or greater.

If an active crossover is not used, solder the supplied capacitors to the positive inputs of the 47KSMT25 crossovers. Cover solder joints with heat shrink.

